

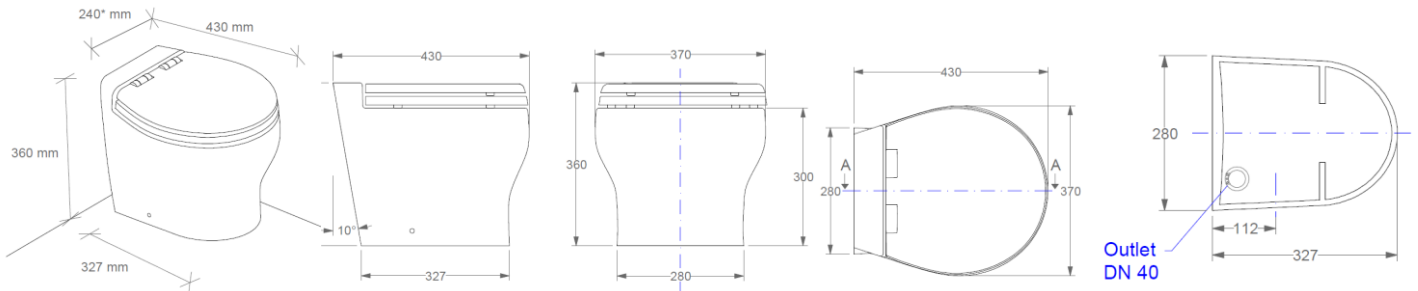

PRODUCT INFORMATION SHEET

ELEGANCE 2G CUT SHORT



Product line	Flexi line 2G
Collection	ELEGANCE 2G CUT
Code	Depending on configuration – see code chart for details

	STANDARD CONFIGURATION	OPTIONAL CONFIGURATION
Outlet pump*	MAC 11 [DC power: 12V- 24 V]	MAC11 [AC power: 220-240 V 50 or 60 Hz / -110-125V 60Hz]
Seat & Cover	Wooden Polyester	Wooden polyester Soft Closing /Thermosetting soft closing/Thermosetting standard
Color	White	Bone, Black
Control Panel	All-in-One 1P SFT / All-in-One 2P SFT 	Multiframe 2P SFT / Touch Multifunction SFT 
Water inlet device*	Solenoid (centralized fresh water system)	Inlet pump (single raw water system)
Bidet		- No matching bidet - Integrated bidet spray nozzle function with side mounted faucet
Water consumption	0.5 / 2.7 l (0.1-0.7 gal) per flush. The user can easily adjust the water amount.	
Weight	19 Kg (41.8 lb) (fully assembled)	

*see technical data for details

Technical data:

WIRE GAUGE SIZE CHART		
Distance from source* is:		
	1-2 m	> 2m
12V DC	11 AWG (4.17 mm ²)	9 AWG (6.63 mm ²)
24V DC	13 AWG (2.63 mm ²)	11 AWG (4.17 mm ²)
110-125V AC 60Hz	18 AWG (0.82 mm ²)	18 AWG (0.82 mm ²)
220-240V AC 50Hz or 60 Hz	18 AWG (0.82 mm ²)	18 AWG (0.82 mm ²)

*Distance measured assumed power and ground wires

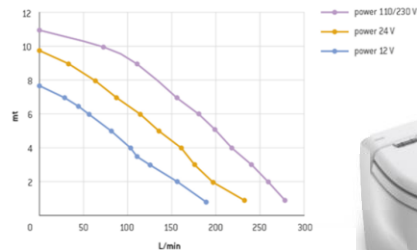

MAC 11	OUTLET PUMP	12V DC	24V DC	110-125V AC 60Hz	220-240V AC 50Hz or 60 Hz
	Fuse recommended	40A	30A	8A	5A
	Pump performance	Max 270L/min 71.3 gpm Max vertical head 11mt 36.1 ft Max horizontal distance 90 mt 295.3 ft			
	Outlet Duck bill valve (male)	1.5" /required ID 1.5" (38.5 mm)			

INLET SOLENOID Centralized system	12V DC	24V DC	110-125V AC 60Hz	220-240V AC 50Hz or 60 Hz
Power consumption	9.5 W	10 W	6 W	6 W
Working pressure recommended	3 bar	3 bar	3 bar	3 bar
Solenoid Inlet and Outlet (threaded female)	1/2"			
Toilet inlet hose fitting (barbed)	20mm			

INLET PUMP Single system (Raw water)	12V DC	24V DC
Fuse	8 A	4 A
Pressure	45 PSI - 3 bar	
Water flow	12 l/min 3.17 gpm	
Toilet inlet hose fitting (barbed)	20mm	

Notes:	For versions with integrated bidet function: 3/8" female connection for cold and hot water supply. Install using the Fischer L-bracket provided / use stainless steel fastener
Box dimension	67cm x 50 cm x 75 cm (LxWxH)
Packaging (units/pallet)	12